



STUDENT EXPERIENCE NETWORK **CONFERENCE ILLUMINATE**



NOV

18

-

21

CELEBRATING

25 YEARS



2024 PROGRAM

INDEX

EVENT PARTNERS

INFORMATION

PROGRAM

SEN EXPO

SOCIAL EVENTS



**We would like to “Shine a Light” on the support
of our Event Partners for SENCON 2024**

PLATINUM PARTNERS



GOLD PARTNER

ACCESSIBILITY PARTNER



SILVER PARTNERS



INFORMATION

LOCATION

- SENCON 2024 is being held at RMIT University, kindly supported by our member on campus, RMIT Student Life. A map of the Campus, can be found at [HERE](#)
- Monday Pre-Conference Welcome Networking Event will be held at Sea Life Melbourne - Location and Transport Details [HERE](#)
- The SEN Awards Gala Dinner will be held in The Pavilion at The Arts Centre Melbourne - Location and Transport Details [HERE](#)

TRANSPORT & PARKING

You all find all Transport and Parking Information [HERE](#)

PROFESSIONAL NETWORKS

On Registration you will be provided with a coloured lanyard of your choice to identify your chosen Professional Network Group to fellow delegates. Please Note: You are welcome to attend any sessions, regardless of nominated Professional Network.

MANAGEMENT
STRATEGY
GOVERNANCE

CLUBS AND
SOCIETIES

STUDENT
SUPPORT

Volunteering and
Welfare & Wellbeing

COMMERCIAL
RETAIL

ADVOCACY

STUDENT
ENGAGEMENT

Events & Activities and
Marketing & Communications

SOCIAL MEDIA

We want to ILLUMINATE the online experience of your conference experience and connect with our members. To do this, we encourage you to use our official hashtags when posting on social media. By using these hashtags, you'll help us reach our members and foster meaningful discussions. Here are the official hashtags for our event:

CONFERENCE: **#SENCON2024**
AWARDS: **#SENAWARDS2024**



INFORMATION

CONFERENCE APP

We are excited to introduce the SENCON 2024 Conference App, designed to illuminate your conference experience. This app will be your essential guide, providing everything you need at your fingertips, including the full program, speaker information, venue maps, and tools to help you connect with other delegates. The app will shine a light on all aspects of the event, ensuring you stay informed and connected. Be sure to download it to explore, engage, and enhance your SENCON journey!

Scan the QR Code and follow the instructions to download the app.



FOOD AND DRINK

Morning Tea, Lunch and Afternoon Tea will be provided throughout the conference. Please ensure you have advised us of any dietary requirements. A coffee and tea station will be available for the duration of the conference, located near the Registration Desk. Catering will be provided by The Oxford Scholar Hotel, located in the heart of RMIT City Campus.

SENSORY QUIET SPACE

There will be a dedicated Sensory Quiet Space at SENCON to provide a tranquil and comfortable environment for those in need of a break from the hustle and bustle. This space has been designed to accommodate your sensory needs and ensure a peaceful retreat during the event.

Location of the Quiet Space space will be available at the Registration Desk.

ACTIVATION WALL

As part of our celebration of SEN's 25-year anniversary, we invite you to visit the Activation Wall, located on the walls throughout the building. This interactive display will shine a light on SEN's history, showcasing a vibrant collection of photos and memories from events over the past 25 years. In the spirit of reflection and community, we encourage you to illuminate this journey by adding your own memories to the wall using the provided post-it notes. Whether it's a special moment from a past SENCON or a meaningful interaction at a networking event, let's come together to highlight the moments that have shaped SEN's legacy.

SENCOn SCAVENGER HUNT

Get ready to "Illuminate" your conference experience and "Shine a Light" on RMIT Campus! SENCOn Scavenger Hunt is designed to lead you through 25 unique locations across the campus and surrounding area! Solve creative clues to uncover each spot and snap a selfie at every destination as you explore.

Submit your responses via the online form by the end of lunch on Thursday for your chance to win a prize. All completed and correctly submitted entries will go into the draw, with the winner revealed during Conference Close on Thursday. You will find cards with a QR code to the form at the Registration Desk.

Let the hunt begin, and may your discoveries illuminate new connections!

PROGRAM

Sessions are colour coded for Professional Networks as follows:

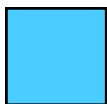

Management / Governance / Leadership



Student Engagement - Marketing & Comms, Events & Activities



Student Support - Welfare & Wellbeing, Volunteering

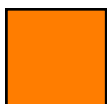

Commercial



Clubs & Societies

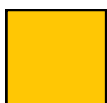

Advocacy



Relevant to Multiple Networks

Click on each Session to provide you with Session and Speaker Details.

MONDAY 18TH NOVEMBER

6:30pm -
8:30pm

SEA LIFE
Melbourne

PRE-CONFERENCE WELCOME NETWORK EVENT

Start "Illuminating" your conference experience with a networking event to meet and connect with delegates from other SEN member organisations.

TUESDAY 19TH NOVEMBER				
8:00AM - 9:00AM	REGISTRATION			
8:30AM - 9:00AM	NEWCOMERS SESSION			
9:00AM - 9:15AM	WELCOME TO COUNTRY			
9:15AM - 9:30AM	CONFERENCE WELCOME			
9:30AM - 10:00AM	OPENING ADDRESS Professor Sherman Young - Deputy Vice Chancellor Education - RMIT University			
10:00AM - 10:30AM	Morning Tea			
10:30AM - 11:30AM	OPENING KEYNOTE Resilience: Illuminating Paths Through Adversity Jessica Zammit - Founder of Life ReParked			
11:30AM - 11:40AM	Move to Next Session			
11:40AM - 12:30PM	Shining a Light on the Online Student Experience	Academic Integrity Perspectives and Current Trends	SEN Awards Finalists Showcase - Welfare & Wellbeing Initiatives	Student Pulse Panel 1
12:30PM - 1:15PM	Lunch			
1:15PM - 2:00PM	Professional Network Sessions 1			Student Representatives Networking Session
2:00PM - 2:10PM	Move to Next Session			
2:10PM - 2:50PM	SEN EXPO	Data vs Human-centric Approach to Student Services	University of Toronto Students' Union - Student Refugee Program	Student Pulse Panel 2
2:50PM - 3:20PM	Afternoon Tea			
3:20PM - 4:20PM	SEN EXPO	SEN Awards Finalists Showcase - Welfare & Wellbeing Initiatives	SEN Awards Finalists Showcase - Clubs & Societies Initiatives	Shining a Light on SEN - An Overview of SEN's Strategic Plan/Initiatives
4:20PM - 5:20PM			RMIT Campus Tour	
5:30PM - 7:00PM	POST EXPO NETWORKING EVENT Alumni Courtyard, RMIT University			

WEDNESDAY 20TH NOVEMBER						
8:00AM - 8:30AM	REGISTRATION					
8:30AM - 9:00AM	<u>SEN PRO - Creating a Tracking Board of Features</u>		<u>SEN Awards Finalists Showcase - Digital Initiatives</u>		<u>SEN Awards Finalists Showcase - Sport & Recreation Initiatives</u>	
9:00AM - 9:10AM	Move to Next Session					
9:10AM - 10:10AM	<u>Quantifying and Advocating for the Financial Value of Student Organisations</u>	<u>Commercial in 2025 - What is Coming Up</u>	<u>Tik Tok - How Can it Really be Useful for High Ed</u>	<u>Creating a Community: Building and Evolving your Volunteer Program</u>	<u>Managing Club Finances</u>	<u>Gender-based Violence on Campus and the Role of Student Legal and Advocacy Services</u>
10:10AM -10:40AM	Morning Tea					
10:40AM - 11:40AM	<u>Connecting With Your Deep Purpose to Inspire & Motivate</u>	<u>Supplier Presentations</u>	<u>SEN Awards Finalists Showcase - Marketing Initiatives</u>	<u>Free Recreational Activities Run by Student Volunteers</u>	<u>ATO and ACNC - Reporting Obligations</u>	<u>Inclusive by Design: IDEAs in Action</u>
11:40AM - 11:50AM	Move to Next Session					
11:50AM - 12:50PM	<u>Is Your Workplace Built for Thriving</u>	<u>Lion Data Analysis</u>	<u>Students and Sustainability on Campus</u>	<u>Beyond Food Relief: Thinking Outside the Box to Promote Student Food Security</u>	<u>Trauma Informed Complaints Management & Investigations</u>	<u>Arc's IDEA Roadmap</u>
12:50PM - 1:30PM	Lunch					
1:30PM - 2:30PM	<u>Governance Structures in Student Led Organisations: Navigating Change and Compliance</u>		<u>Exploring Avenues to Support Student Voice in a Genuine Way</u>		<u>Rethinking the Place of Food on Australian Campuses</u>	<u>Foodbank Victoria CEO</u>
2:30PM - 2:40PM	Move to Next Session					
2:40PM - 3:40PM	<u>Board Inductions For Not-for-profits: Setting Your Group up for Success</u>	<u>SEN Awards Finalists Showcase- Commercial Initiatives</u>	<u>Top Trends in Student Publications</u>	<u>Food Security Panel</u>	<u>Managing Risks at Off-Campus Events</u>	<u>Learnings from ACUI Panel</u>
3:40PM - 4:10PM	Afternoon Tea					
4:10PM - 5:10PM	<u>SEN PRO - The Complete Solution</u>	<u>Illuminating Club Success: Streamlining Governance with Engaging Resources</u>		<u>SEN Awards Finalists Showcase - Digital Initiatives</u>	<u>Co-designing Responses to Cult Recruitment on Campus</u>	

THURSDAY 21ST NOVEMBER						
8:00am - 8:30am	REGISTRATION					
8:30am - 9:30am	<u>Connecting Co-Curricular Experiences to Strategic Employability Outcomes</u>	<u>Coffee of Campus - Member Experiences</u>	<u>SEN Awards Finalists Showcase - Event or Activity</u>	<u>SEN Awards Finalists Showcase - Volunteering Initiatives</u>	<u>6 R's of Succession Planning</u>	<u>Mirror, Mirror on the Wall... Advocacy Frameworks and Reflective Practices</u>
9:30am - 9:40am	Move to Next Session					
9:40am - 10:40am	<u>Risk Ready: Strategies for Confident Decision Making with AI</u>	<u>SEN Awards Finalists Showcase - Food & Beverage Initiatives</u>	<u>SEN Awards Finalists Showcase - Event or Activity</u>	<u>SEN Awards Finalists Showcase - EDI Initiatives</u>	<u>Designing Leadership Programs</u>	<u>How are Students Engaging with GenAI? An Overview of Emerging Insights</u>
10:40am -11:10am	Morning Tea					
11:10am - 12:10am	<u>Understanding Finances</u>	<u>Student Bars Post COVID</u>	<u>SEN Awards Finalists Showcase - Orientation Initiatives</u>	<u>Peer-Led Empowerment: A Pathway to Preventing Gender-Based Violence</u>	<u>Managing Challenging Conversations 1</u>	<u>Guiding Lights - Student Co-creating the Campus Experience</u>
12:10am - 12:20pm	Move to Next Session					
12:20pm - 1:20pm	<u>Budgeting and Financial Health</u>	<u>4 Ways to Lead in 2025</u>	<u>SEN Awards Finalists Showcase - Orientation Initiatives</u>	<u>The Anxiety Project - Beside Myself</u> <u>Therapy in the Age of the Dog</u>	<u>Managing Challenging Conversations 2</u>	<u>SEN Awards Finalists Showcase - Advocacy Initiatives</u>
1:20pm - 2:00pm	Lunch					
2:00pm - 2:45pm	<u>Professional Network Sessions 2</u>					
2:45pm - 3:00pm	Move to Next Session					
3:00pm - 4:00pm	<u>Closing Keynote Speaker</u> <u>Grace “IamFallFromGrace”</u> <u>Sponsored by Red Bull</u>					
4:00pm - 4:10pm	CONFERENCE CLOSE					
4:10pm - 6:30pm	FREE TIME					



STUDENT EXPERIENCE NETWORK AWARDS GALA DINNER

6:30PM - LATE

The Arts Centre Melbourne

Pre-Dinner Drinks and Canapes

3 Course Plated Meal

Entertainment - DJ

Dress - Cocktail / After 5

Join us for a Gala evening where we will announce and celebrate the winners of the 2024 Student Experience Network Awards

AWARDS GALA DINNER ENTERTAINMENT



Pre-dinner drinks entertainment will be provided by Jasmine Iona. Jasmine is a student at Melbourne Polytechnic and the winner of our National Campus Music Comp for June 2024.

Jasmine is a singer-songwriter and producer hailing from the Eyre Peninsula. Grappling with themes of grief, love and family trauma, her self-produced songs string heartfelt narratives from stars, mud and meteorites against a backdrop of shimmering synths. Jasmine's upcoming EP is set for release in 2025. She is currently based in Melbourne, Australia.

Our MC and DJ for the evening will be Calum Marshall. For the past 8 years, Calum has been DJing in nightclubs, at weddings, and private functions all over Victoria. He's been passionate about music for as long as he can remember.

Calum loves the energy of a dance floor enjoying themselves, letting go of their fears and just throwing down. He believes that it is an honour to be involved in any function and he is blessed to be part of it.



SEN EXPO

The SEN Expo is an opportunity to engage and build relationships with suppliers in the industry. See new concepts and products, with plenty of samples available.

The Expo will be located in Storey Hall - Building 16, Level 5.

See Map [HERE](#)

EXHIBITOR FLOOR PLAN

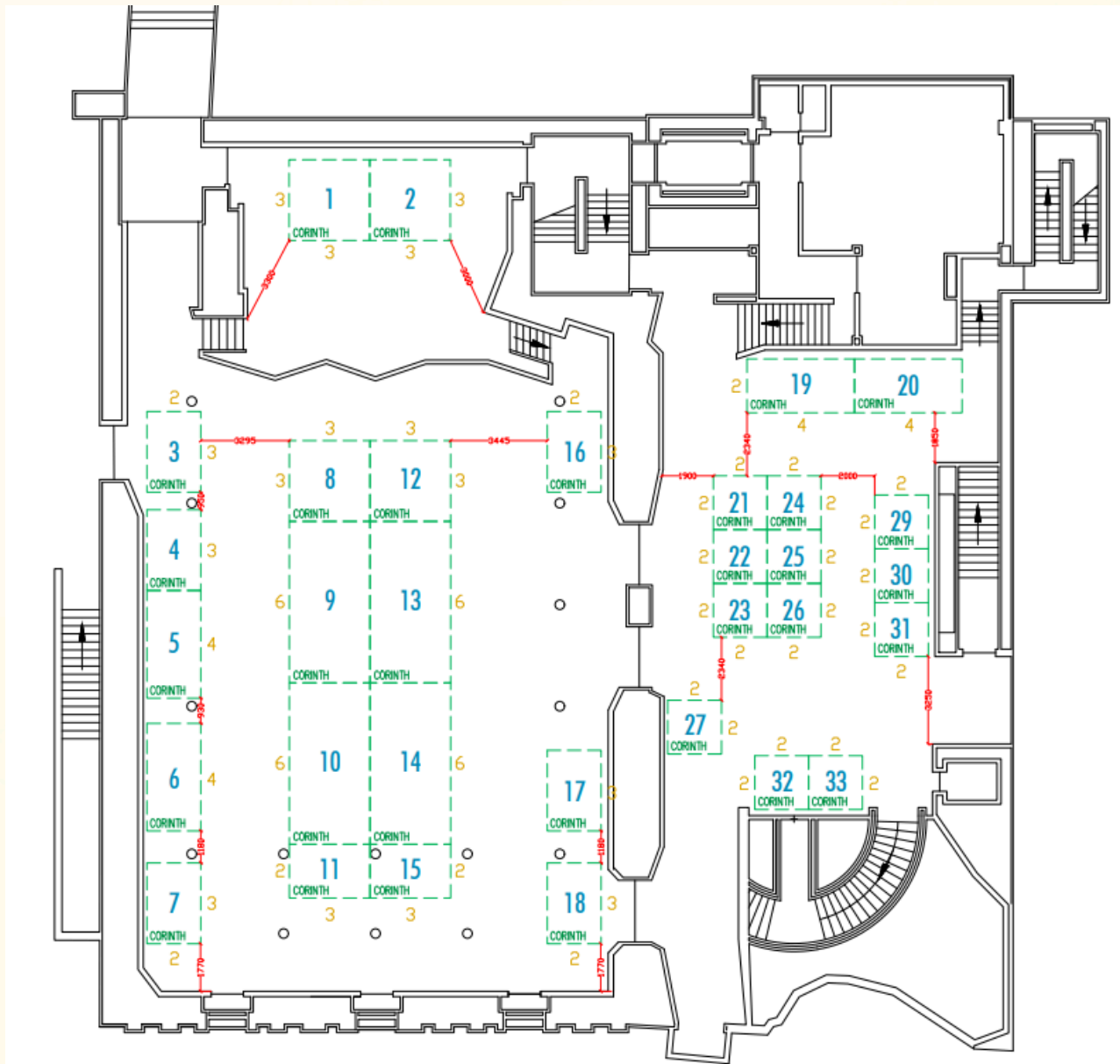

EXHIBITOR FLOOR PLAN

Stall Number	Exhibitor Name
1	De Bortoli Wines
2	OxyShred Energy
3	Illuminating Your Merch - SEN Members Marketing Display
4	Sanitarium The Health Food Company
5	SCOODA - Educated Merchandise
6	Bluegum
7	Bacardi
8	Provender
9	Asahi
10	Red Bull
11	Ivend
12	The Smiths Snackfood Company
13	Lion Beer
14	Replenish Vending
15	Streets Ice Cream
16	SAMESAME
17	Coca-Cola Europacific Partners
18	Huhtamaki

EXHIBITOR FLOOR PLAN

Stall Number	Exhibitor Name
19	Coopers Brewery
20	Suntory Oceania
21	Connect National Audit Pty Ltd
22	CPR Group
23	SENPPO
24	Itea 4 U
25	Patties
26	The Distributors Group
27	Recite Me
28	Eustralis Food
29	The Kettle Chip Company
30	A&T Trading
31	iPOS
32	Community Laptop Packages

Thanks to our Service Partner Think Productive, all delegates will also receive a Free ticket to their new workshop - "Thriving Teams in Tricky Times".

You can find the flyer with the QR to redeem your ticket in your SEN Expo Bag, along with some other goodies from our valued suppliers.



PRE-CONFERENCE WELCOME NETWORK EVENT

Join us for an unforgettable welcome networking event at the stunning SEA LIFE Melbourne Aquarium! Dive into the evening with fellow conference attendees, surrounded by mesmerizing marine life. Enjoy a delightful array of food and drinks as you connect and engage with peers in a unique and vibrant setting. This special event promises to be a perfect start to SENCON 2024, fostering new connections and setting the tone for an inspiring conference experience.

DATE - Monday 18th November 2024

TIME - 6:30pm - 8:30pm

VENUE - SEA LIFE Melbourne

<https://www.visitsealife.com/melbourne/>



POST EXPO NETWORKING EVENT

Following the Expo and Day 1 of SENCON 2024, take a break and join us for an “illuminating” networking event at RUSU After Dark! Mingle with fellow attendees in a lively atmosphere, enjoying delicious food and refreshing drinks. This event is the perfect opportunity to unwind, share insights from the conference so far, and forge new connections in a relaxed and vibrant setting. Don’t miss out on this exciting evening! Entertainment will be provided by RMIT Student, Nick Psomopoulos

DATE - Tuesday 19th November 2024

TIME - 5:30pm - 7:00pm

**VENUE - Alumni Courtyard, RMIT University –
377 Russell St, Melbourne - See Map [HERE](#)**

***Please Note – In the event of rain, the event will be moved to RUSU After Dark, located in Building 78, Cardigan St.**

COST - FREE

